

**REFERENCE DRAWINGS FOR CABLE DIVERSIONS**

- 13-03-01-HOL/24/335 HOLFORD BRINEFIELD - KGSP
- PROPOSED 11KV OVERHEAD CABLES DIVERSION ADJACENT TO WELLHEAD H505
- 13-03-01-HOL/24/336 HOLFORD BRINEFIELD - KGSP
- PROPOSED 33KV OVERHEAD CABLES DIVERSION ADJACENT TO WELLHEAD H506
- 13-03-01-HOL/24/337 HOLFORD BRINEFIELD - KGSP
- PROPOSED 11KV OVERHEAD CABLES DIVERSION ADJACENT TO WELLHEAD H508
- 13-03-01-HOL/24/338 HOLFORD BRINEFIELD - KGSP
- PROPOSED 11KV OVERHEAD CABLES DIVERSION ADJACENT TO WELLHEAD H509
- 13-03-01-HOL/24/339 HOLFORD BRINEFIELD - KGSP
- PROPOSED 11KV OVERHEAD CABLES DIVERSION ADJACENT TO WELLHEAD H514

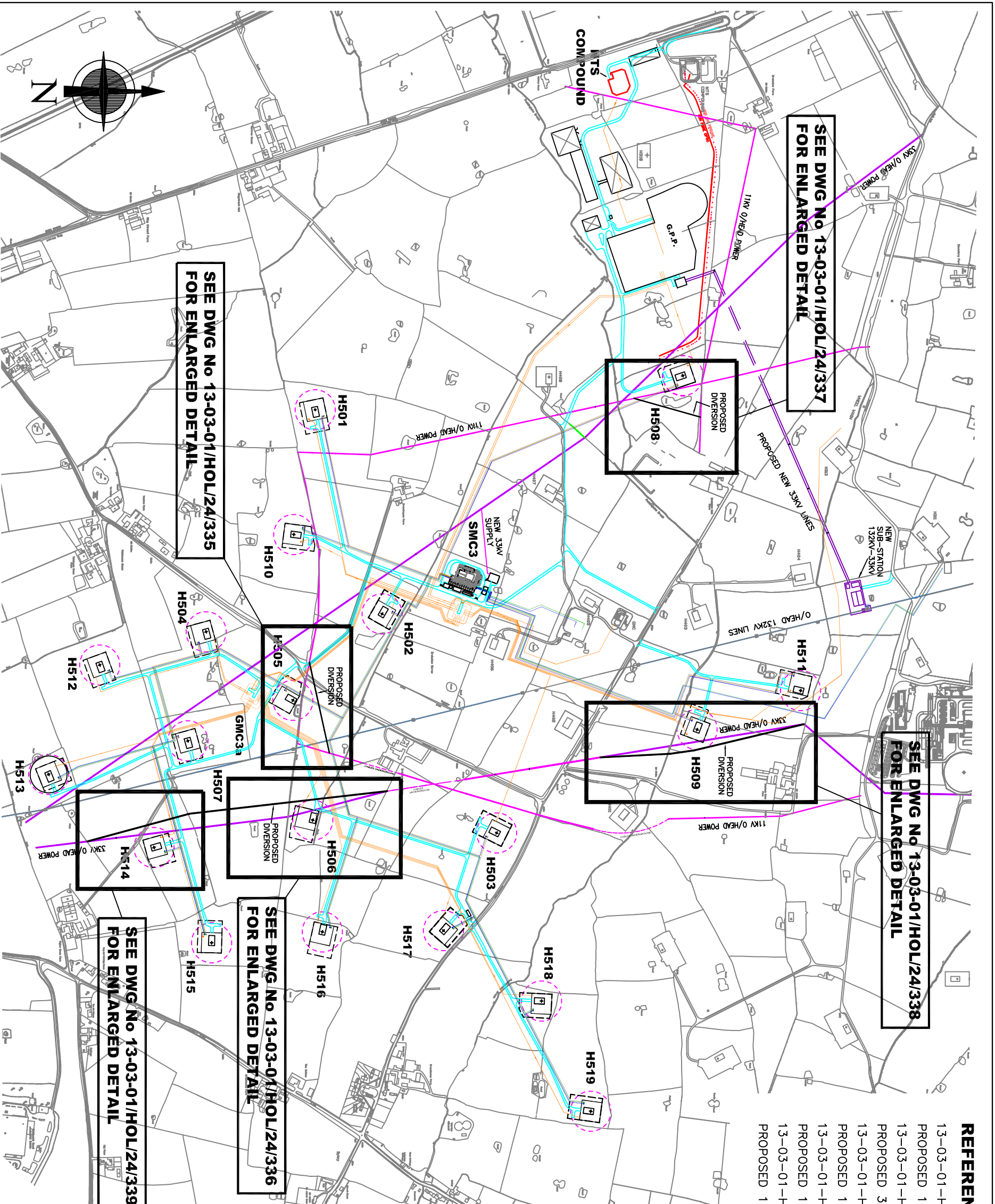

SEE DWG No 13-03-01/HOL/24/337 FOR ENLARGED DETAIL

SEE DWG No 13-03-01/HOL/24/338 FOR ENLARGED DETAIL

SEE DWG No 13-03-01/HOL/24/335 FOR ENLARGED DETAIL

SEE DWG No 13-03-01/HOL/24/336 FOR ENLARGED DETAIL

SEE DWG No 13-03-01/HOL/24/339 FOR ENLARGED DETAIL

**LEGEND**

- = EXISTING 33KV OVERHEAD POWER LINES (ON POLES)
- = EXISTING 33KV POWER U/GROUND
- = EXISTING 11KV OVERHEAD POWER LINES (ON POLES)
- = EXISTING 11KV POWER U/GROUND
- = EXISTING 132KV OVERHEAD POWER LINES (PYLONS)
- = WELLHEAD COMPOUND WITH 50m SQUARE PERIMETER FENCE
- = CONSTRUCTION FENCE 80m x 60m
- = CAVITY OUTLINE
- = GAS FLOWLINE
- = WATER MAIN
- = BRINE MAIN
- = NITROGEN
- = BRINE MAIN
- = ACCESS ROAD
- = G.P.P. = GAS PROCESSING PLANT
- = NTS = NATIONAL TRANSMISSION SYSTEM

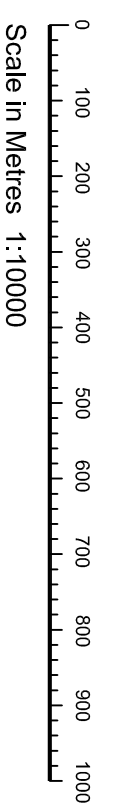

**HOLFORD BRINEFIELD - KGSP - OVERHEAD CABLE DIVERSIONS AT WELLHEADS H505, H506, H508, H509 AND H514 - KEY PLAN**

TITLE		HOLFORD BRINEFIELD - KGSP - OVERHEAD CABLE DIVERSIONS AT WELLHEADS H505, H506, H508, H509 AND H514 - KEY PLAN	
REV	CHG'D BY	DATE	DESCRIPTION
B1	DP	26.10.2015	FOR DCO APPLICATION
	AL		ALTERATIONS

THIS DRAWING IS PRIVATE AND CONFIDENTIAL AND IS THE PROPERTY OF KEUPER GAS STORAGE LIMITED. IT MUST NOT BE COPIED OR LENT WITHOUT THE CONSENT OF KEUPER GAS STORAGE LIMITED BRINE AND WATER SECTION AND MUST BE RETURNED WITH TENDER AND / OR ON COMPLETION OF ORDER.		<b>KEUPER GAS STORAGE LIMITED</b> BRINE AND WATER SECTION, NORTHWICH SITES, HOLFORD BRINEFIELD, LOSTOCK GRALAM, NORTHWICH, CHESHIRE, CW9 7TD.	
THIS DRAWING HAS BEEN GENERATED USING CAD BUT UNDER NO CIRCUMSTANCES SHOULD REVISIONS BE MADE TO THE DRAWING EXCEPT BY UPDATING THE CAD MASTER IMAGE. IF ANY DOUBT EXISTS PLEASE CONTACT HOLFORD DRAWING OFFICE FOR CONFIRMATION OF CURRENT DRAWING STATUS.		<b>WARNING</b>	

DATE	APPROVED BY	SCALE	PROJECT No.
02/02/2015	AI	1:10000	EN030002
DATE	DESIGNED BY	PLANT REF	APPLICATION NUMBER
02/02/2015	DP		EN030002
DATE	ISSUED BY	SCALE	PROJECT No.
02/02/2015	DP	1:10000	13-03-01/HOL/24/334